

# MEDIA SALES OFFICE 2023

## 1. BUCHAREST

- AFI PARK
- AFI TECH PARK 1
- AFI LAKEVIEW
- AFI PARK FLOREASCA
- AFI VICTORIEI PLAZA

## 2. BRASOV

- AFI PARK BRASOV

## 3. TIMISOARA

- AFI PARK TIMISOARA



# AFI PARK

Completely integrated with AFI Cotroceni mall, AFI Europe developed **AFI Park** office buildings, the first class A modern business project in Bucharest.

\*AFI Park 2 is not subject to advertising



10 floors (AFI Park 1&3), 12 floors (AFI Park 4&5)



9,500 employees

1,100 visitors/ day



Facilities:

AFI Cotroceni mall proximity

Parking

Restaurants/ Coffee-shop

Banks



**Tenants:** AFI Park 1: Crys Computers, Ecta 74 Software, Endava Romania, Microchip Technology, Sparkware Technologies. AFI Park 3: Callpoint New Europe, Endava, IDEA Bank, Lagardere Travel Retail. AFI Park 4: Cameron, Casa Magica, FIS, Miron Instal, NBI, Ortec, Sebino, Secure Works, Schlumberger, Veeam, Sii Romania, Telus International, Wellness Center. AFI Park 5: Bullguard, Cameroon, Endava, Fotonation, Incryc, Pinum, SecureWorks, Tucano, Telus, Veeam, Vivo.



# AFI TECH PARK

AFI Tech Park is a class A business park, near J.W. Marriott hotel and Palace of Parliament. The project will include 3 office buildings: AFI Tech Park 1 was delivered in Q1 2018 and we're currently working on AFI Tech Park 2.



8 floors



1,800 employees

250 visitors/ day



Facilities:

Parking

Restaurants

Coffee-shop



Tenants: 1 Minute, Afcon, CertSign, Connect, Ecovis, Game World, Gourmet, Hilti, Knauf, Ludan, Mazda, Panasonic, Reynaers, RTC, Tangoe, World Class, WWF, YTS Dental.

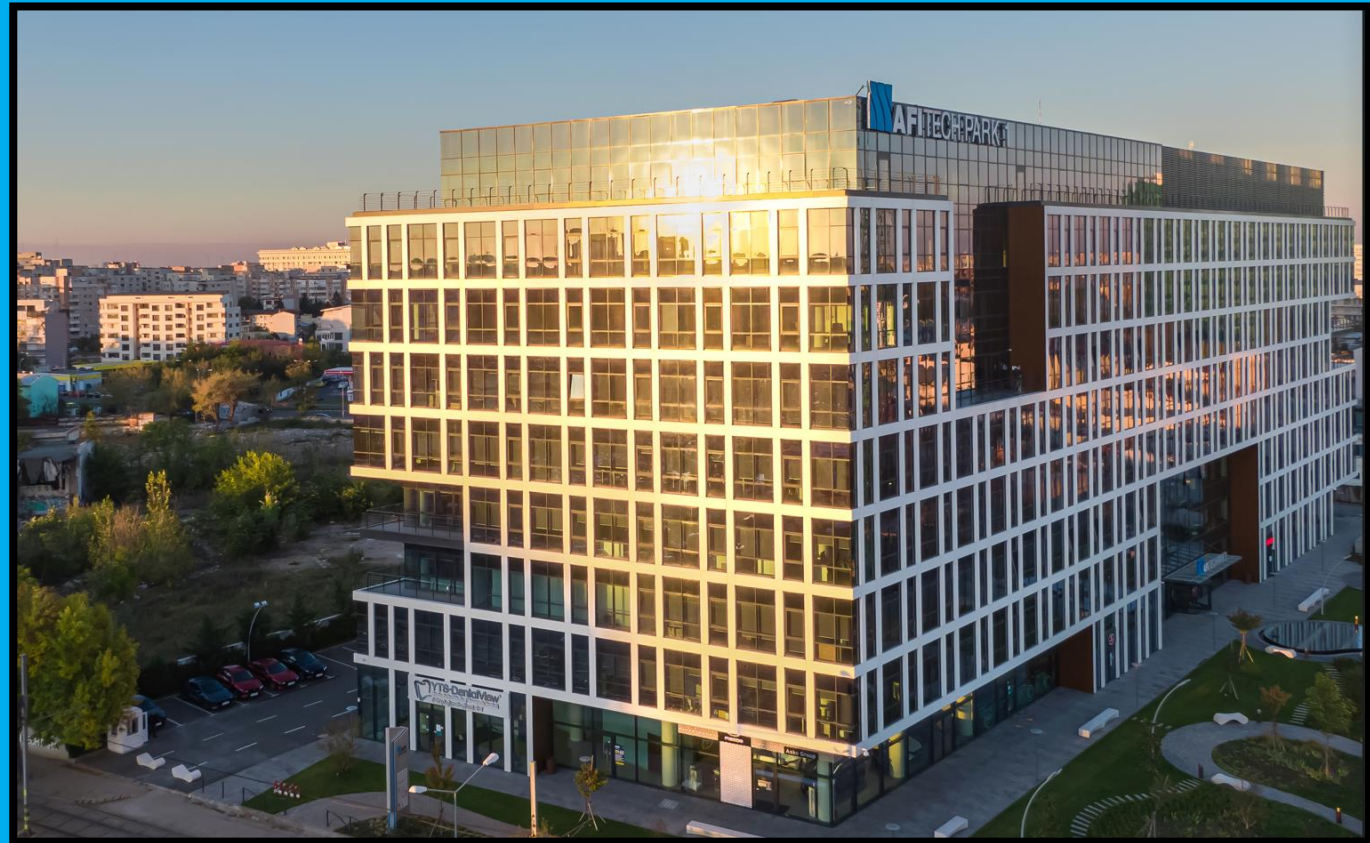

# AFI LAKEVIEW

Located in the emerging business district of Bucharest, **AFI Lakeview** combines A-class standard and efficiency with excellent access and visibility.



14 floors



3,000 employees

250 visitors/ day



Facilities:

Parking

Press-point

Canteen



Tenants: Abbvie, Alcon, Huawei, LeasePlan, Novartis, Philips, PwC.

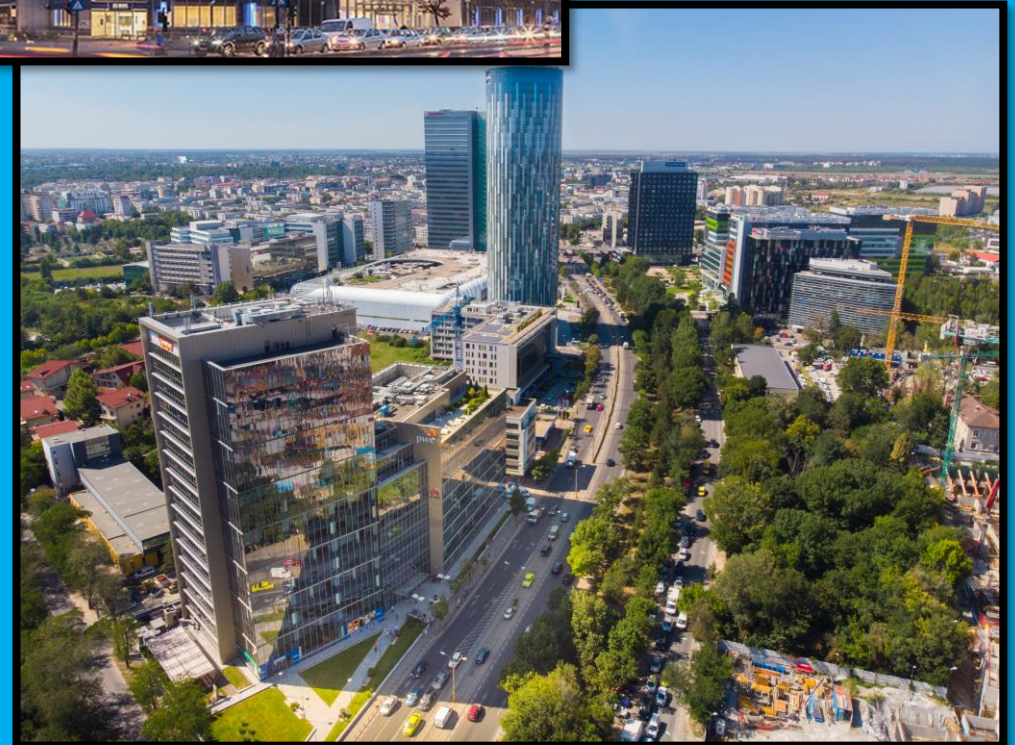

# AFI PARK FLOREASCA

AFI Park Floreasca sets a new level in technical specification whilst also providing excellent natural light from all sides and great views of the green area to the West.



2 buildings  
8 floors/ building



3,500 employees  
250 visitors/ day



Facilities:

Parking

Commercial area



Tenants: Berlin Chemie, Colliers, Daikin, DHL, Exxon Mobil, Federal Mogul, NepiRockcastle, Goodyear, Holcim, L'Oreal, Lenovo, Mars, Regus, Royal Canin, Sandoz, Wipro.



# AFI VICTORIEI PLAZA

AFI Victoriei Plaza is proud to have the most modern façade of an office building in Romania. A combination of outstanding design and uncompromisingly high specifications creates the ultimate modern working environment.



3 floors



750 employees

600 visitors/ day

Facilities:



Parking

Commercial area

Restaurants



Tenants: CBRE, 5ENSI, AV8, Fitbit, French Revolution, General Electric, Manufactura by Doncafe, Qreator by IQOS.



# AFI PARK BRASOV

AFI Park Brasov consists in 2 “Class A” office buildings integrated into the AFI Brasov mall. The first office building was delivered in October 2020.



12 floors



1,000 employees

100 visitors/ day



Facilities:

Parking

Commercial area

Restaurants



Tenants: Siemens, NTT.

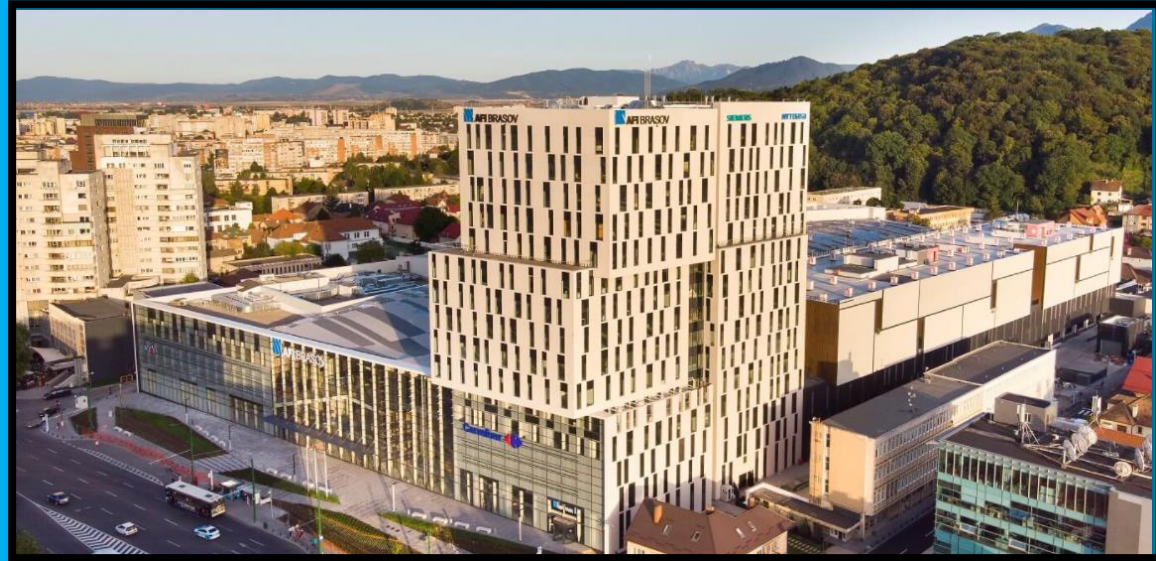



# AFI PARK TIMISOARA

AFI Park Timisoara is a modern A class business park consisting of 5 office buildings built at the highest technical standards, located in the heart of Timisoara city.



5 buildings

4 floors/ building



4,400 employees

150 visitors/ day

Facilities:



Parking

Banks

Restaurants

Press point



Tenants: Accenture, SAP, Deloitte, Wipro, IBM, Wisma, Hella.

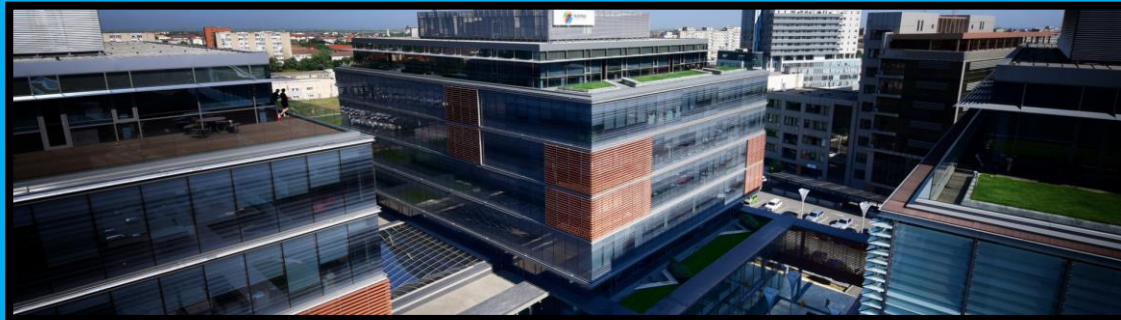

# MEDIA SALES

SPACE	SPECIFICATIONS	PRICE/ITEM	PERIOD
Elevator frames	29.7 x 42 cm (A3)	75 euro	month
Elevator frame - big size <i>(available in AFI Park Timisoara only)</i>	39,50 x 39,50 cm	75 euro	month
Toilet frames <i>(available in AFI Park Timisoara only)</i>	42 x 59 cm	75 euro	month
Underground pannel <i>(available in AFI Lakeview only)</i>	290.4 x 136.7 cm	100 euro	month
Promotional stand**	1 - 4 sqm	150 euro	day
Promoter	1 person	15 euro	hour
Videowall <i>(available in AFI Park 1 only)</i>	1920 x 1080 px .mp4 / .mov	300 euro	month
Car exposure		900 euro	month
Filming location		750 euro	day



\* Prices don't include VAT.

\*\*Price may vary according to project dimensions

# MEDIA SALES

## Elevator frames

<b>AFI Park 1</b>	18 pcs (29.7 x 42 cm - A3)
<b>AFI Park 3</b>	14 pcs (29.7 x 42 cm - A3)
<b>AFI Park 4</b>	18 pcs (29.7 x 42 cm - A3)
<b>AFI Park 5</b>	18 pcs (29.7 x 42 cm - A3)
<b>AFI Tech Park</b>	14 pcs (29.7 x 42 cm - A3)
<b>AFI Park Floreasca A</b>	16 pcs (29.7 x 42 cm - A3)
<b>AFI Park Floreasca B</b>	14 pcs (29.7 x 42 cm - A3)
<b>AFI Lakeview</b>	17 pcs (29.7 x 42 cm - A3)
<b>AFI Park Timisoara A</b>	3 pcs (29.7 x 42 cm - A3) + 3 pcs (39,50x39,50 cm)
<b>AFI Park Timisoara B</b>	3 pcs (29.7 x 42 cm - A3) + 3 pcs (39,50x39,50 cm)
<b>AFI Park Timisoara C</b>	4 pcs (29.7 x 42 cm - A3)
<b>AFI Park Timisoara D</b>	4 pcs (29.7 x 42 cm - A3)
<b>AFI Park Timisoara E</b>	4 pcs (29.7 x 42 cm - A3)

## Toilet frames

<b>AFI Park Timisoara A</b>	15 pcs (42x59 cm)
<b>AFI Park Timisoara B</b>	14 pcs (42x59 cm)
<b>AFI Park Timisoara C</b>	16 pcs (42x59 cm)
<b>AFI Park Timisoara D</b>	16 pcs (42x59 cm)

## Underground pannels

<b>AFI Lakeview</b>	4 pcs (290.4 x 136.7 cm)
---------------------	--------------------------



## **LAURA DRĂGUȚ**

Corporate Advertising Manager

email: [Laura.Dragut@afi.global](mailto:Laura.Dragut@afi.global)

Mobile: 0754 042 336

## **CARMEN BĂJENARU**

Advertising Sales Specialist

email: [Carmen.Bajenaru@afi.global](mailto:Carmen.Bajenaru@afi.global)

Mobile: 0741 126 096